

Watson-Marlow Pumps Group
Telephone +44 (0) 1326 370370
Fax +44 (0) 1326 376009
E-mail: info@watson-marlow.co.uk
www.watson-marlow.com

Members of the Spirax Sarco Engineering Group



The information contained in this document is believed to be correct, but the Watson-Marlow Pumps Group accepts no liability for any errors it contains, and reserves the right to alter specifications without notice.

WARNING
 This product is not designed for use in, and should not be used for, patient-connected applications.

PB0336/10

	323Dz/D 400rpm 323Dz/RL 300rpm		+5C, +41F
	<70dBA@1m		+40C, +104F
	323Dz/D 4.7kg 10lb 6oz 323Dz/RL 5.6kg 12lb 6oz		-40C, -40F
			+70C, +158F



323Dz/D, 323Dz/RL

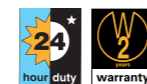
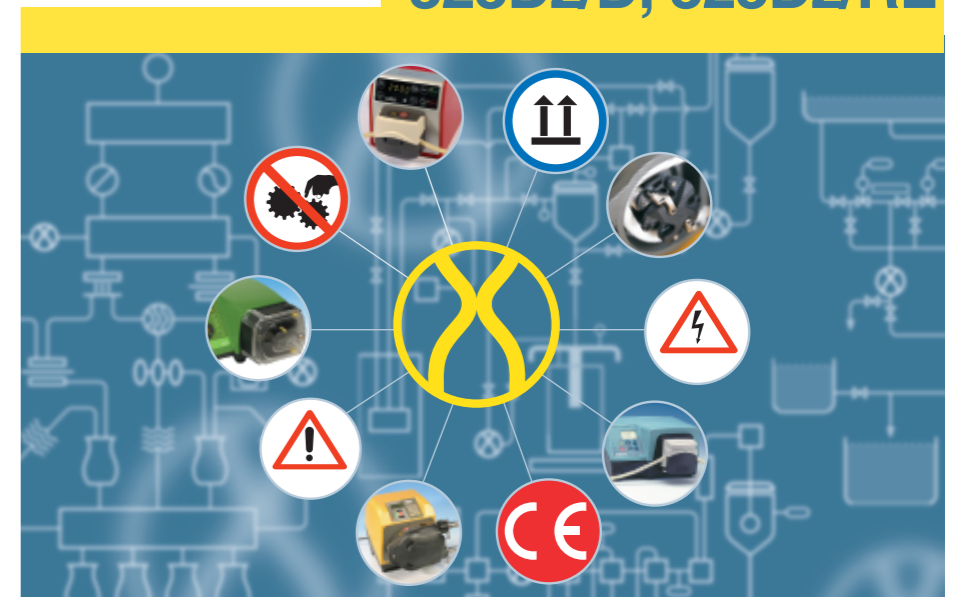

David Cole
 David Cole, Managing director



2006/42/EC, 2004/108/EC,
 2006/95/EC, BS EN60529 (IP31),
 2006/42/EC, UL61010-1,
 CAN/CSA-C22.2 No 61010-1



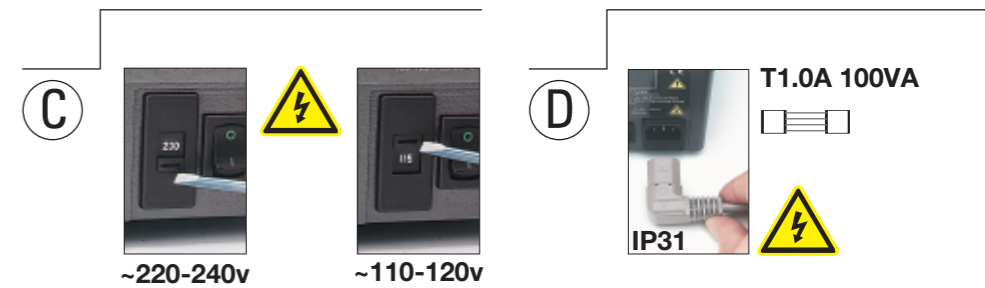
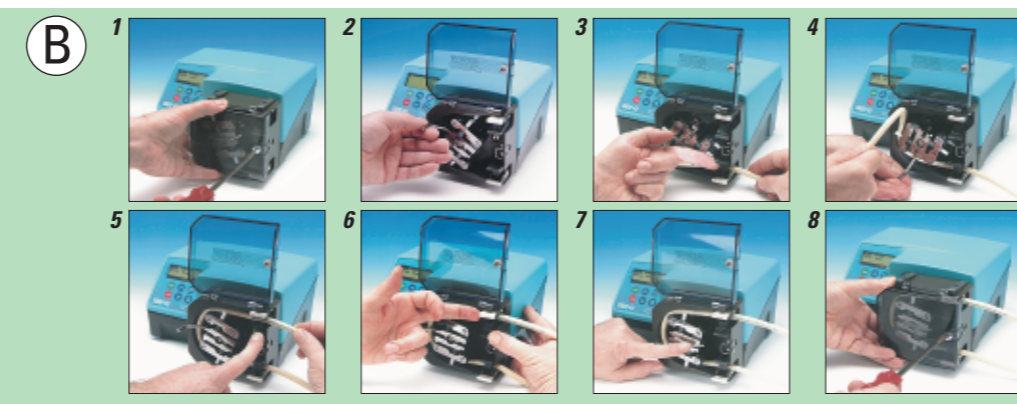
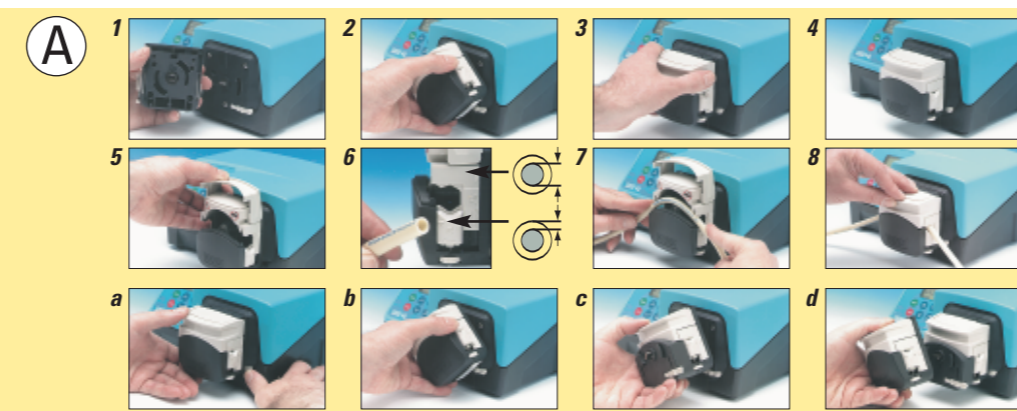
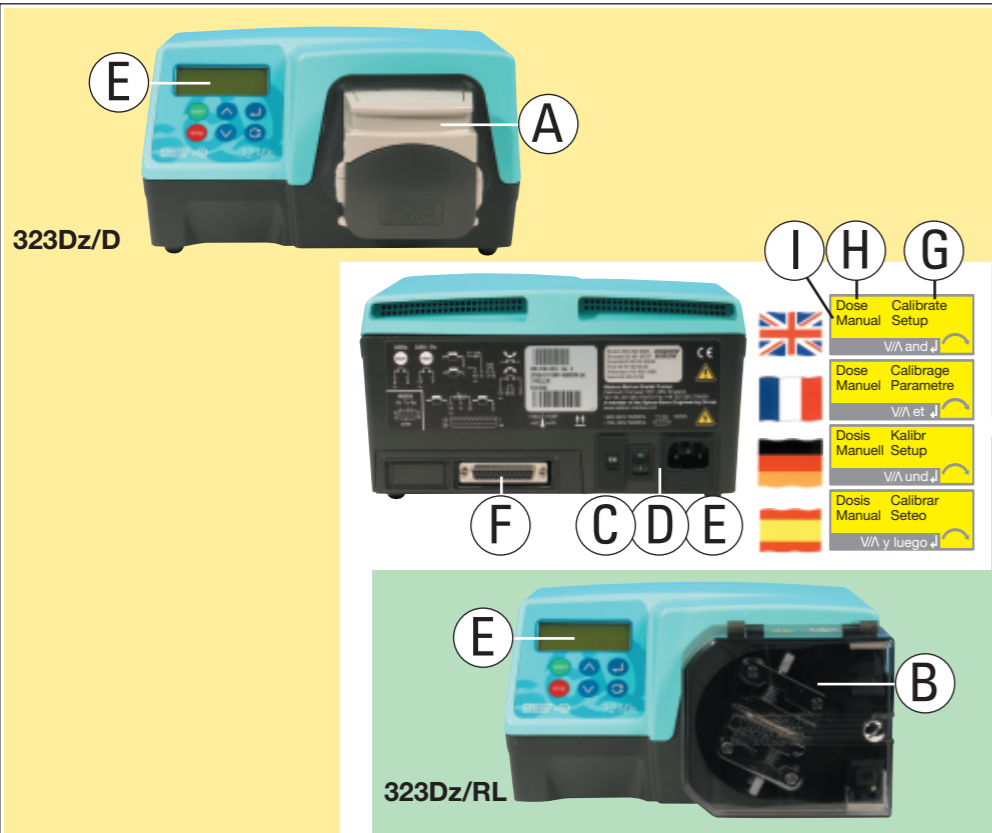

H		1		2		3		4		5		6		7		8		9	
UK	ml	Interval	n Doses	rpm	Direction	Start ramp	End ramp	Revs=drip	Proceed										
FR	ml	Intervalle	n Doses	tr/mn	Rotation	Rampe depart	Rampe fin	Tours=retours	Executer										
DE	ml	Intervall	n Dosis	upm	Richtung	Start rampe	Ende rampe	Reverse=drip	Ausfuehren										
ES	ml	Seg interv	n Dosis	rpm	Sentido giro	Rampa inicio	Rampa final	Revs=antigoteo	Continuar										

